

PUBLIC ENERGY PRESENTS

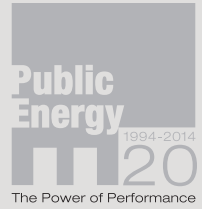

# Erring on the Mount

THREE DAYS OF ART AND PERFORMANCE



**May 30 – June 1, 2014**

The Mount Community Centre, 1555 Monaghan Road, Peterborough

# Erring on the Mount

Welcome to the final event in Public Energy's 20th anniversary season. To mark the occasion we're producing an event that really shows the world what we do – the diversity of artistic styles and collaborations, and our commitment to trying new things while not losing sight of how we got here. It's not often that the past plays a role in a festival of forward-thinking art, but it seems appropriate as we enter our third decade.

The history of the Mount is well known to those who have interacted with the building and the Sisters of St. Joseph over the years. What is less known is that the idea for Erring on the Mount comes from an event staged in Peterborough in 1996. Credit for the special way in which the word erring is used belongs to the artists of the Union Theatre, who created the first Erring as an imaginative response to being removed from their home at the time.

That event, and its title, have stuck with me all these years – their memory a constant reminder that the best artmaking is always worth the risks taken to pull it off. So it is in that spirit that we use the word erring, drawing as much on the Latin meaning *to wander* or *stray* as *to be mistaken*, to describe an event in which artists and audiences alike search for new and unusual experiences in an unfamiliar place. Here's wishing you good luck and that you won't make too many mistakes as you stray among the art and artifacts of Erring on the Mount.

- **Bill Kimball**, *Artistic Producer*

## BEHIND THE SCENES

**Artistic Producer:** Bill Kimball

**Curator:** Elizabeth Fennell

**Production Manager:** Esther Vincent

**Lighting Coordinator:** Ryan Kerr

**Sound Coordinator:** David Bird

**Site Manager:** Paul Oldham

**No Man's Land Curator:** Judith A. Mason

**Publicity Coordinator:** Michael Fazackerly

**Development Director:** Simone Georges

**Video Documentation:** Steve Rose, PowerHouse Digital

**Graphic design:** Laurel Paluck

**Program design:** Rob Wilkes, big sky design

**Front of House and Volunteer Coordinator:** Tara Lember

## MANY THANKS

To everyone at the new Mount Community Centre - John Martyn, Bill Pyle, Stephen Kylie, Jamie Hueston, Lois Tuffin, and everyone else working on this worthy project. To our new friends at Mount St. Joseph, including Sister Joan Driscoll, Joe Keast, Tony DeLaire. Also Jim Gleason, Tracy Shumate, Caroline Langill, Bryan Sablay, City of Peterborough Geomatics & Mapping, and McWilliams Moving. And to all the artists who created the first Erring in 1996, thanks for the inspiration.

## AN ACT OF FAITH

Curating a first-time multi-artists festival is an act of faith. It involves not only trust, but conviction, that the end result will reward the effort; that the funding will come; that the organizers, artists, and public, will come; that together we will all experience something transformative and transcendent. The result of that act of faith is now on display for all to see at Erring on the Mount.

Over seventy proposals from writers, actors, dancers, painters, sculptors, musicians, photographers, and storytellers were submitted in response to our public call. Artistic producer Bill Kimball and I ultimately chose 51 works that most fit the festival goals passed down to us from the original Erring artists\*. Multidisciplinary, site-specific, site-responsive, and collaborative new works would transform unusual spaces into artworks, but instead of apartments over a bar, we are using two wings of a de-consecrated convent.

Site-specific/site-responsive art engages with architecture in a way that traditional gallery and theatre pieces do not. Traditional settings for experiencing art ask the works to conform to a designated 'blank canvas'; art and performances fit within the boundaries of a mutable gallery or theatre and divisions between audience and creators are understood and accepted. In site-specific art, the physical space is the starting point of the work; the guiding principal that inspires the creators is the history and function of the location, and the resulting works reflect the legacy of place.

For Erring on the Mount, Public Energy brings you public art for an untraditional space: the former Motherhouse of the Sisters of Saint Joseph, now known as the Mount Community Centre, future home of an inclusive and diverse community, yet to be established. The Sisters have moved to a new home next-door, more in keeping with their current numbers and role in the community - but for over one hundred years, the site was the bustling home of over 300 nuns, carrying out good works of education and healing in this community and beyond. The home, with its chapels, dormitories and even infirmary, was once full of stained glass and statuary, icons of the Catholic faith, and remnants and echoes of the Sisters' lives and religion remain in traces that cannot ever be erased or removed.

The site however, is undergoing many changes, and Public Energy has been given the opportunity to aid in the transformation process. By inviting artists to speak to the site, we investigate its place in the communal imagination, and each artist's work forms a response. Some challenge, some chide, others honour and extol. Turning a former convent into a temporary artistic experience is risky, but our hope is that it generates the kind of *public energy* that occurs when risk-taking artists come together with openhearted audiences. We have faith that you will enjoy experiencing it, as much as we have had in the making of it.

- **Elizabeth Fennell**, *Curator*

*\*Some original Erring artists have returned for this one:*

*David Bateman, Brad Brackenridge, Kim Blackwell, Ryan Kerr, Kate Story, Esther Vincent.*

## PROGRAM A ADMISSION BY DONATION

**Friday May 30, 2pm-6pm**

**Saturday May 31, 2pm-6pm**

**Sunday June 1, 3pm-6pm**

See all the installations plus performances by these artists:

**All 3 days:** Janel Jarvis, Hermione Rivison, Christy Stoeten

**Saturday and Sunday only:** the above artists plus Andrew Mark & Sally Morgan, Jessica Rowland, Zippa Dee Doo Dah Day Soul Chorus

## PROGRAM B ADMISSION: \$20 FOR ONE DAY

**Friday May 30, 7:30pm-10pm** *doors open 6:30, with 2 opening night special events.*

**Saturday May 31, 7:30pm-10pm** *doors open 6:30*

**Sunday June 1, 1pm-3:30pm** *doors open noon*

See all the installations plus performances by these artists:

**All 3 days:** David Bateman & Em Glasspool, Kim Blackwell, Brad Brackenridge, Jenn Cole, Opal Jennifer Elchuk, Ryan Kerr, Sarah McNeilly, New Stages Theatre, Susan Newman, Kate Story

**Friday only opening night special events:** *Feeding the Sisters* (Thomas Olszewski & Liz Osawamick) at 6:30pm, Janel Jarvis at 7pm

**Friday and Saturday only:** Max Price & Hilary Wear

## INSTALLATIONS ON VIEW DURING BOTH PROGRAMS

**Works by:** Kathleen Adamson, Lester Alfonso, Joeann Argue, Douglas Back & Sara Bradley, Paul Cade, Jan-Paul Campeau with Roz Hermant and Victoria Wallace, Rowena Dykins, Robert Edmondson, Anne Gaensbauer, Judith Graham, Ann Jaeger, Mary Kainer, Cameron Kuntz, Ramune Luminaire, B. Leigh Macdonald, Jeffrey Macklin & Phillip Chee, Dave Maher, John Marris, Judith A. Mason, Beth McCubbin, Holly McClellan, Tegan Moss & Paul Atchison, Paul Oldham, Kelly O'Neill, Laurel Paluck, Michael Poulton, Quilt Arts Peterborough, Deb Reynolds, Margaret Rodgers, Joan Scaglione, Bronson Smith, Sally Thurlow, Gillian Turnham & Hartley Stephenson, Esther Vincent

**Advisory:** Erring on the Mount is a program of contemporary art with some provocative religious and sexual themes and imagery, although you won't see anything here that you wouldn't see in the Sistine Chapel. Nevertheless, labels with descriptions are posted to assist parents and guardians as to the appropriateness of content within individual rooms.

## TICKETS

**Program A:** admission by donation

**Program B:** \$20 for one day

**Multi-Show Pass:** \$35 gains admission to Program B on any two days and Program A on all three days. With the Pass you are (almost) guaranteed seeing all performances in both programs.

Available at the door or in advance from the Market Hall Box Office, on line at [markethall.org](http://markethall.org) or by phone 705-749-1146.

## HOW TO EXPERIENCE ERRING ON THE MOUNT

**First, choose a program:** A or B. They are the same, yet different.

**What's the same: The art installations.** You can see all 34 installations in different rooms and spaces around the Mount on both programs.

**What's different: The performances.** The two programs feature entirely different performances and require a different approach for taking them in. Program A is laid back, with 4 of its 6 performances designed for dropping in on at any time – they are durational. Program B will keep you moving, with just five time slots for the 11 performances, and 15 minute breaks in between most. Don't worry, 15 minutes should give you enough time to go from one performance to another and look at some art on the way. There are also a few performances between the main time slots, so if you hurry you can catch 6 or 7 works in Program B.

**Second, come back again to see the artists you missed the first time!** There is only one way to see everything: *Come 3 times.* A Multi-Show Pass to see Program B twice and Program A unlimited times costs \$35.

**What's the catch?** The catch is that your entry to Program A or B *does not guarantee you entry to a particular performance.* Each performance is in a different room with a different capacity, so it is *first-come first-serve* at the door to that room. If the room takes 15 people then the first 15 in line for that room get in. If you are the 16th, then you can move on to another room nearby and (probably) get into that room because the capacity is greater.

**Program B Hot Tip:** *Check out the approximate room capacity listed in the schedule and plan your timing accordingly.* If the capacity is low (15) then plan to arrive at that room earlier than if it is high (75).

## DINNER AT ERRING ON THE MOUNT

**Friday and Saturday, 6pm – 7:30pm** Bridge your Program A experience in the afternoon and Program B in the evening with a meal from **My Grandfather's Kitchen** on Friday and **Food Not Bombs** on Saturday.

## PROGRAM DETAILS

### PROGRAM A PERFORMANCES

**23 Janel Jarvis:** *The Soundtrack That Wasn't There* with Leigh Macdonald, Hartley Stephenson, and Victoria Wallace  
Found 8mm home movies from the late 1950s/early 1960s will be shown with live choral accompaniment in the naturally dark and acoustically magnificent Trunk Room.

Janel Jarvis works as an accompanist, piano teacher, vocal coach and recreation facilitator. She also very much enjoys teaching bellydance and has been at it for 16 years.

**45 Andrew Mark and Sally Morgan:** *Lostsolastalgia*  
Responding to the fragmented architecture and the dream residues that The Mount radiates, *Lostsolastalgia* is a durational performance installation rooted in concepts of mourning environmental loss and placelessness. Composed of sound and movement inspired by/from working with site as collaborator, Morgan and Mark investigate loss and resistant mourning.

Sally Morgan and Andrew Mark are both performing artists and scholars working on interdisciplinary projects merging Environmental Studies and Fine Arts.

**37 Hermione Rivison:** *All It Takes is Faith*  
Hermione is fascinated by the story of Abraham, and how faith is reflected in our communities. Stories from the Mount are mirrored with his story. This piece is a reflection of these, as she asks what characteristics make Abraham the leader that he is, and how faith plays out in the life of a Sister.

Hermione Rivison slipped into storytelling after working in theatre. Now her performances are the old, timeless stories; fairytales, fables, teaching tales from around the world and personal tales. She is involved in Peterborough Storytellers and is available for workshops and house concerts.

**33 Jess Rowland:** *Sumido: Quiet Pandemonium*  
Interactive participatory art in which one person at a time, every 15 minutes, is guided to a remote room to be... interviewed? ...interrogated? ...given an experience ...and to become momentarily a part of the installation-performance.

Jess Rowland is an interdisciplinary artist who has decided that the labyrinthine corridors of the Mount are perfect for a psychological intrigue and improvisational interactive performance. A graduate of Nova Scotia College of Art and Design, she has worked in video, performance, poetry, and installation art, often through Public Energy's Emergencies and Alley Waltzes.

**36 Christy Stoeten:** *Until Tender-Crisp* with Sonia Gemmiti  
A one-on-one experience between performer and voyeur. A secret look into the cyclical nature of life, exploring themes of time, nostalgia and isolation.

The lure of sparkling costumes brought Christy Stoeten to dance class at the age of three in Peterborough, Ontario. A graduate of the School of Toronto Dance Theatre, Christy is an independent dance artist working in Toronto.

**16 The Zippa Dee Doo Dah Soul Chorus:** *The Singing Sinners of Mercy*  
Under the direction of Curtis Driedger. Filling the chapel with song, as in the days of old.

Curtis Driedger is involved in a wide range of musical endeavors, both short and long term, in the Peterborough area. The Zippa Dee Doo Dah Soul Chorus is just one of his community-based projects.

### PROGRAM B PERFORMANCES

**14 David Bateman and Em Glasspool:** *Cock on a Hot Convent Roof*  
A new work from Peterborough's Mysterious Entity Theatre, both art installation and performance, which explores memory, Tennessee Williams, and the rooster-infused bowling lanes of two gender-addled imaginations.

David Bateman is a visual artist and performance poet who teaches creative writing and literature at a variety of Canadian universities. He has presented his work internationally over the past 25 years. Em Glasspool is the artistic director of Peterborough's Mysterious Entity Theatre, and has been working in theatre as a director, performer, writer and musician for the past 20 years.

**47 Kim Blackwell:** *Les Soeurs (The Sisters)* performed by Maude Rose Craig, Avery Francis, and Chloe Poch-Goldin  
A verbatim theatrical experience exploring the lives of three Sisters of St. Joseph, as told by three little girls, ages seven and eight. The piece will incorporate movement and music to tell the stories of these women's lives, in their own words. It is also a physical exploration of younger people inhabiting characters almost eight decades older than themselves.

Kim Blackwell is the Managing Artistic Producer at 4th Line Theatre and is in her 20th season with the company where she has directed 13 productions including five world premieres. Upcoming she will be directing Alex Poch-Goldin's *The Bad Luck Bank Robbers* at 4th Line and Maja Ardal's *HER2*, a Nightwood/Buddies in Bad Times Theatre co-production.



**35 Brad Brackenridge:** *Murmuratio* with Melody Thomas

Peterborough's puppet-based theatre company, The Nervous System, presents its first 'puppopera'. Live operatic accompaniment adds an epic element to Brackenridge's compelling mix of puppet styles, including marionettes, shadow, and Sicilian-rod puppets.

Brad Brackenridge is a local actor, designer and puppeteer. For the past 25 years he has performed in hundreds of projects for theatre, film, television, dance and beyond. In 2010 his company, The Nervous System was founded to create and produce new theatrical works combining puppetry and live action, and strong design elements, in collaboration with artists of all disciplines. Soprano Melody Thomas received her operatic training from University of Toronto, and Wilfrid Laurier. Currently based in her hometown of Peterborough, Thomas is teaching, performing and preparing for graduate school.

**41 Jenn Cole:** *Good Dirt* with Myrto Koumarios and Gina J. Brintnell

Inspired by Jean Anouilh's *Antigone*, this piece moves dancer against dirt and dirt against dancer. A young woman relentlessly digs to bury her brother. Her commitment to a world in which one digs, knowing it is both futile and lethal and does it anyway, performs an affirmation that puzzles those around her.

Jenn Cole is a small-time dancer and choreographer, with interest in unsent letters, anonymous installation work, inarticulacy, and big messes.

**15 Opal Jennifer Elchuk, with Tessa Nasca and Thomas Voccaro:** *Creatures of Flight*

Exploring the connection between earth and spirit through a dance between ground and air. Ethereal bird creatures, nesting in the far reaches of the building, playfully traverse the unique architecture of the Mount.

Opal Jennifer Elchuk is an aerialist, dancer, and visual artist who has been producing art in Peterborough for over eight years. Her work is inspired by the natural world, the human body and her insatiable desire to climb things. Tessa Nasca loves to explore expression and storytelling through movement and play. She is a circus artist with a long-standing hoop practice and a budding interest in aerial dance. Thomas Voccaro is head of the fire performance troupe, the PyroFlys. His commitment to using circus arts to improve the community is his passion.

**2 Janel Jarvis:** *Cellydancing in the Gardens of the Mount* with cellist Mateusz Swoboda and dancers Carmen Gelette, Sarah Rudnicki

A trio of bellydancers accompanied by cello will do a performance in celebration of spring in the gardens.

Janel Jarvis works as an accompanist, piano teacher, vocal coach and recreation facilitator. She also very much enjoys teaching bellydance and has been at it for 16 years.

**38 Ryan Kerr:** *Periphery*

A solo dance performance investigating the interactions of men (both religious and secular) with the women of St. Joseph's.

Ryan Kerr is the artistic director of Fleshy Thud and The Theatre on King. He has been creating theatre and dance in Peterborough since 1993.

**46 Sarah McNeilly:** *Francie and the Golden Key* with Stephanie Cann, Spencer Allen, Miranda Warren, Victoria Silvera, Andrew McNeilly, Caren McNeilly

This adaptation of a whimsical fairy-tale, narrated by an orphan character, is a sensory performance that explores the power of narrative (both literary and personal).

Sarah McNeilly is an actor, dancer and vocalist whose most recent performances include: performing in every serial at the Theatre on King (*The 5000 Fingers of Dr. T, Young Frankenstein* and *Pennies from Heaven*), *The Orator* (Showplace) and *Scan* with Danse Carpe Diem (Public Energy).

**19 Susan Newman:** *A Sea Change Suite* with The Convivio Chorus

The imminent transformation of The Mount inspired Susan Newman to compose a suite of songs for the Convivio Chorus, drawn from the text of Shakespeare's *The Tempest* with its theme of the constancy of change.

Susan Newman has been active in the Peterborough arts community for over 30 years as a musician, actor and composer. She is the founding director of the Convivio Chorus which has been a regular feature of the annual In From the Cold concert for the past 14 years.

**18 New Stages Theatre:** *Into Temptation* written by Mary J. Breen, performed by Dianne Latchford, directed by Randy Read, Madonna by Anne Cavanagh

Dolores Grogan turns to the Blessed Virgin for help with her troubled conscience.

Randy Read is Artistic Director of New Stages, a professional theatre in Peterborough and has worked as a casting director at CBC Radio and Canadian Stage and as an actor at theatres across Canada. Dianne Latchford has been a professional stage, film and television actor for over 30 years. She is also a musician, singer/songwriter and an emerging visual artist, with a solo art show currently at Black Honey.

**25 Thomas Olszewski:** *Feeding the Sisters*

*Feeding the Sisters* is a simple act of sharing. In a garden behind the Mount, Thomas Olszewski will plant a vegetable garden featuring the 'three sisters' - corn, beans, squash. On the opening day of the festival, at 6:30pm, Thomas will invite Liz Osawamik (Anishinaabe from Wikwemikong First Nation) to say a prayer for the seeds prior to planting, then offer some food to those present. In the fall he will prepare a meal for the Sisters at the Mount using the harvest from this garden.

Thomas Olszewski (Anishinaabe from Rama First Nation) is the owner and proprietor of a catering company called Grandfather's Kitchen here in Peterborough. He is also an artist whose work often explores the relationship and conflict of traditional knowledge in a contemporary world.

**Max Price and Hilary Wear: *Seven Daily Sins***

Playing with very human habits, this collaborative performance displays behaviours of two sisters “caught in the act” and uses elements from tableaux vivants, dance and clown. Watch for the sisters throughout the building, on your way to or from performances during Progam B on Friday and Saturday.

Max Price is a former dancer. Although life had different plans, Max has found his way back in the spotlight by creating Max’s Cabaret, a series of regular cabaret shows benefiting the community. Hilary Wear is a local theatre artist who loves community work, clowning, collaborating, being cast in roles, receiving teachings, and playing with people(s). Her clown character, Tootah, is off to the Toronto Fringe Festival this summer to pick up some trash.

**24 Kate Story: *A place you’d go to find something, something you’d left there*** with David Bird

Springboarding from the Sisters’ stories about the Trunk Room, “something you’d left there” explores departure and return, how our own lives can over time keep secrets from us, and the wordless places: body and spirit.

Kate Story is a writer and performer. She creates works that contain elements of dance and theatre, often in collaboration with other artists. David Bird is an audio engineer, singer-songwriter, photographer, and poet. His work focuses on the intuitive, liminal spaces of our world.

## ABOUT THE MOUNT COMMUNITY CENTRE

The Mount Community Centre came into existence out of a single belief - that the option to redevelop the historic former home of the Sisters of St. Joseph was too good an opportunity to lose. These 10 acres in the middle of the City of Peterborough has 131,400 square feet of buildings - including housing, a commercial kitchen, chapel and more.



The founders of this new non-profit organization knew this would make a wonderful setting for a diverse self-sustaining village within the city. The more The Mount Community Centre founders looked at the options for redeveloping the property, the more clear it became that the sturdy buildings and the undeveloped land, if used right, could be the perfect setting for a blend of non-profit and private tenants that would serve several community needs. A variety of community partners supports that vision by lending their expertise and staff time to develop the plans and welcome the first new tenants to the Mount.

The Mount is always looking for potential tenants, extra donations for their work and extra hands to move this project ahead. Please contact the Mount Community Centre at [themountpeterborough@outlook.com](mailto:themountpeterborough@outlook.com)

## COMING NEXT FROM PUBLIC ENERGY...



**DUSK DANCES**  
coming to Rotary Park  
again this summer!

**July 24 – 27**  
**Nightly at 7pm**

Featuring dance, music and performance for the entire family with works by: **Throwdown Collective, Denise Fujiwara, Julia Aplin, Andrea Lithgow and special guest Montreal flamenco artist Myriam Allard.**

With opening band, Peterborough’s **Nick Ferrio & His Feelings**

**A Fueled By Public Energy event**

Edge of the Woods Theatre Presents

# Ralph + Lina

By Christina Serra, Michele Smith and Dan Watson

**Friday June 6 – 8pm**  
Market Hall Performing Arts Centre, 140 Charlotte St.  
Tickets Online: [www.markethall.org](http://www.markethall.org)  
By Phone: (705) 749-1146  
Or in person at The Gentry & Moondance Records

★★★★★  
“Physical theatre at its finest”  
-Stage Door Reviews

★★★★★  
“...charming, funny, piercing...”  
-The Examiner Review

★★★★★  
“..Zest and Vibrant Energy”  
-Now Magazine

“Christina Serra’s wide-eyed performance is adorable in the extreme”  
-Globe and Mail

Logos for sponsors: THEATRE Smith-Gilmour, CANADA COUNCIL, THEATRE ONTARIO, CANADA COUNCIL ON THE ARTS, WILSON, and others.

## PERFORMANCE PROGRAM A **FRIDAY, MAY 30**

DURATIONAL WORK. DROP IN ANY TIME DURING THE PERIOD SHOWN

ARTIST	#	duration				
<b>Christy Stoeten</b>	<b>36</b>	<b>2:00-3:30</b>				
TIME-LIMITED WORKS						
ARTIST	#	running capacity time (approx.)	running time (approx.)	START TIMES		
<b>Hermione Rivison</b>	<b>37</b>	75	0:40	4:00		
<b>Janel Jarvis</b>	<b>23</b>	35	0:10	4:15	4:45	5:15 5:45

## PERFORMANCE PROGRAM A **SATURDAY, MAY 31**

DURATIONAL WORK. DROP IN ANY TIME DURING THE PERIOD SHOWN

ARTIST	#	duration				
<b>Christy Stoeten</b>	<b>36</b>	<b>2:00-3:30</b>				
<b>Jess Rowland</b>	<b>33</b>	<b>2:00-5:30</b>	<i>one person admitted approx. every 15 minutes</i>			
<b>Andrew Mark &amp; Sally Morgan</b>	<b>45</b>	<b>3:00-4:00 and 4:30-5:30</b>				
<b>The Zippa Dee Doo Dah Soul Chorus</b>	<b>16</b>	<b>3:30-4:10</b>				
TIME-LIMITED WORKS						
ARTIST	#	running capacity time (approx.)	running time (approx.)	START TIMES		
<b>Hermione Rivison</b>	<b>37</b>	75	0:40	4:00		
<b>Janel Jarvis</b>	<b>23</b>	35	0:10	4:15	4:45	5:15 5:45

## PERFORMANCE PROGRAM A **SUNDAY, JUNE 1**

DURATIONAL WORK. DROP IN ANY TIME DURING THE PERIOD SHOWN

ARTIST	#	duration				
<b>Christy Stoeten</b>	<b>36</b>	<b>3:00-4:30</b>				
<b>Jess Rowland</b>	<b>33</b>	<b>3:00-5:30</b>	<i>one person admitted approx. every 15 minutes</i>			
<b>Andrew Mark &amp; Sally Morgan</b>	<b>45</b>	<b>3:00-4:00 and 4:30-5:30</b>				
<b>The Zippa Dee Doo Dah Soul Chorus</b>	<b>16</b>	<b>3:30-4:10</b>				
TIME-LIMITED WORKS						
ARTIST	#	running capacity time (approx.)	running time (approx.)	START TIMES		
<b>Hermione Rivison</b>	<b>37</b>	75	0:40	4:00		
<b>Janel Jarvis</b>	<b>23</b>	35	0:10	4:15	4:45	5:15 5:45

## PERFORMANCE PROGRAM B **FRI. & SAT., MAY 30 & 31**

Doors open at 6:30pm. Come early to explore the art installations before the performance program starts.

ARTIST	#	running capacity time (approx.)	running time (approx.)	START TIMES					
<b>Susan Newman</b>	<b>19</b>	300	0:20	7:30					
<b>Ryan Kerr</b>	<b>38</b>	70	0:12	8:00	8:30	9:00	9:30		
<b>Kate Story</b>	<b>24</b>	30	0:15	8:00	8:30	9:00	9:30		
<b>Sarah McNeilly</b>	<b>46</b>	15	0:15	8:00	8:30	9:00	9:30		
<b>Kim Blackwell</b>	<b>47</b>	40	0:15	8:00	8:30	9:00	9:30		
<b>Opal Jennifer Elchuk</b>	<b>15</b>	15	0:15	8:05	8:35		9:35		
<b>Jenn Cole</b>	<b>41</b>	30	0:10	8:05	8:35	9:05	9:35		
<b>Brad Brackenridge</b>	<b>35</b>	30	0:06	8:05	8:20	8:35	9:05	9:20	9:35
<b>D Bateman &amp; E Glasspool</b>	<b>14</b>	60	0:10	8:05	8:35		9:35		
<b>New Stages Theatre</b>	<b>18</b>	100	0:30			9:00			
<b>Max Price &amp; Hilary Wear</b>	Between performances throughout the building								
<b>Friday only pre-show: Two free events</b>									
<i>Take in these in while waiting for the evening program to start. 00:15 each</i>									
<b>Thomas Olszewski:</b>	<b>25</b>	<i>Feeding the Sisters with Liz Osawamick</i>							
		Time: 6:30 Location: Gardens behind the Mount							
<b>Janel Jarvis:</b>	<b>2</b>	<i>Cellydancing in the Gardens of the Mount</i>							
		Time: 7:00 Location: Gardens in front of the Mount							

## PERFORMANCE PROGRAM B **SUNDAY, JUNE 1**

Doors open at noon. Come early to explore the art installations before the performances begin.

ARTIST	#	running capacity time (approx.)	running time (approx.)	START TIMES					
<b>Susan Newman</b>	<b>19</b>	300	0:20	1:00					
<b>Ryan Kerr</b>	<b>38</b>	70	0:12	1:30	2:00	2:30	3:00		
<b>Kate Story</b>	<b>24</b>	30	0:15	1:30	2:00	2:30	3:00		
<b>Sarah McNeilly</b>	<b>46</b>	15	0:15	1:30	2:00	2:30	3:00		
<b>Kim Blackwell</b>	<b>47</b>	40	0:15	1:30	2:00	2:30	3:00		
<b>Opal Jennifer Elchuk</b>	<b>15</b>	15	0:15	1:30	2:00		3:00		
<b>Jenn Cole</b>	<b>41</b>	30	0:10	1:35	2:05	2:35	3:05		
<b>Brad Brackenridge</b>	<b>35</b>	30	0:06	1:35	1:50	2:05	2:35	2:50	3:05
<b>D Bateman &amp; E Glasspool</b>	<b>14</b>	60	0:10	1:35	2:05		3:05		
<b>New Stages Theatre</b>	<b>18</b>	100	0:30			2:30			

# INSTALLATIONS

## 17 Kathleen Adamson: *Cognate*

This audio-visual installation will question relationships between indigenous culture and the Church at a local level, exploring blurred perspective, cultural resonance and dissonance, smothering, distance, charity, and transmuted symbols.

Kathleen Adamson is a classically trained pianist and composer. She premiered her first opera last summer and has recently returned from travelling through Spain studying pilgrimage routes and the monastic influence within small communities.

## 32 Lester Alfonso: *Brion Wagner where are you now?*

Brion Wagner has been a vital member of Peterborough's artistic scene and his disappearance in the winter of 2013 left a void in the community. *Brion Wagner where are you now* is an installation of one of his more ephemeral and temporary works: an oil and dye light projection performed at a house party last summer, recorded by Lester Alfonso, and played back for us, as a reminder of the work we all have to do, "to keep vigilant, keep the faith, and go the extra mile to affirm the beauty of life in gratitude".

Lester Alfonso was a collaborator of Brion Wagner's, and often documented his unique live art experiences using light and projections and music/noise. Writer, filmmaker, photographer and video jockey, Alfonso's original works include award-winning documentaries, one-man plays, architectural video-mapping, and his most recent project, as artist-in-residence for MAP, the ongoing series "What is Art?".

## 49 Joeann Argue: *Contemplation*

What happens when we are alone with our thoughts? When we sit alone in a room with only the far away sounds of everyday life?

Joeann Argue is a trans-media artist working in sculpture, sound, visual art and performance. She is currently completing an MFA in Visual Arts at the Vermont College of Fine Arts.

## 26 Douglas Back and Sara Bradley: *Uplift*

Emulating one of the Sisters' daily chores, laundry. Vibration sensors on the stairs control a winch motor at the top of the stairwell. Forty feet below a linen sheet is soaking in a washtub. As people walk on the stairs the dripping linen sheet is hauled, step by step, to the top of the stairwell.

Doug Back is a tenured professor at OCAD University, and has been making electronic, programmed, mechanical, interactive installations since 1979. Sara Bradley has been a structural engineer for 20 years; this is her first foray into the world of installation art.

## 1 Paul Cade: *The Garden of Infinite Possibilities*

An interactive and collaborative sculpture garden realized from repurposed and recycled materials, visitors are invited and encouraged to join in the creative process and contribute to the beautification of the Mount.

Paul Cade has worked as an illustrator, designer, and film director. His works have won numerous awards nationally and internationally.

## 22 Jan-Paul Campeau: *Rupto Silentio* with Victoria Wallace and Roz Hermant

Using a barrage of chaotic sound, *Rupto Silentio* transforms the ambulatory, the hidden hallway behind the altar originally used by priests for silent passage.

Jan-Paul Campeau is a musician, songwriter and sound designer who composes for video games and various album-recording projects. Roz Hermant is a photo-based artist, inspired by the landscape of wherever she finds herself. Victoria Wallace is a multi-media visual artist working and conducting workshops in acrylic, encaustic, and sculptural media.

## 20 Robert Edmondson: *Exploring the Boundary Between Art & Corn*

This lighthearted kinetic sculpture asks for audience participation by means of a crank in the upper chapel balcony that must be turned to reveal the piece's function and message.

Robert Edmondson is a designer and builder of many things; most recently large scale kinetic sculptures that hope to "reach up and touch the higher sphere of art".

## 3 Anne Gaensbauer: *Natures' Cross and Spirit Rising*

A series of 14 photocollages located around the Auditorium (the Sisters' first chapel) reference the traditional Stations of the Cross and the crucifixion of nature. They are contrasted by wooden sculptural reliefs that allude to hope, and the spirit of awareness within us all.

Anne Gaensbauer is a York University Visual Arts graduate, who lives on the north shore of Stony Lake near the Petroglyphs Park; she draws her inspiration from the land, and uses techniques from various mediums to create her work.

## 42 Judith Graham: *The Cloakroom*

Reminding us that we take our beliefs with us and wear them in everyday life, this interactive multi-media installation invites visitors to explore, create, and wear, clothing in a religious context.

Judith Graham is a visual artist and poet living in Millbrook Ontario. Her past lives as a Buddhist nun, biology instructor and potter exert a strong influence on her work.



**48 Ann Jaeger: *The Permeability of Words***

An experience of language as fluid and impermanent; paying homage to the prayers, conversations, and silences of the Mount Saint Joseph Sisters.

Ann Jaeger is an OCAD University graduate whose work often combines visual art, textiles and writing. She writes Trout in Plaid, an online journal about her love affair with Peterborough's arts and culture scene.

**21 Cameron Kuntz: *Saints In Underwear And Other Stories***

*Saints...* playfully explores the space where the Spiritual and Physical meet - the bodies of Saints. Kuntz's figures speak to the human element within the divine - the secular within the sacred, and the physical or 'profane' within the saintly.

Cameron Kuntz was born in Hamilton, Ontario in 1955, and continues to be inspired by his native city. Art making is just one of his many careers.

**31 Leigh Macdonald: *A Glow in the Dark***

A mixed-media painting presents itself in two forms: one visible in the light, the other in darkness.

Leigh Macdonald finds expression in drawing, painting, taking photographs, playing the piano, and collaborating with other artists using puppetry, costume and lights.

**44 Jeffrey Macklin and Phillip Chee: *Sister Mary's Room of Requirement***

A multi-media installation disguised as a simple room populated with the ephemera of a life, that of a typical resident of Mount St. Joseph.

Jeffrey Macklin is an emerging artist, working primarily in relief printing (letterpress) and mixed media. Phillip Chee works with computers, operating systems, and networks. He creates photographs the rest of the time.

**50 Dave Maher: *From Orphan To Hero***

Inspired by actual events, this installation tells the story of a young child left at the Mount and cared for by the Sisters until his adoption, who became a hero not only to his family and neighbours, but in service to his country during WWII.

Dave Maher is a lifelong Peterborough resident, who studied art under David Bierk. He is most passionate about photography and story telling.

**5 John Marris: *Re-Haunting* with assistance from Phillip Chee**

Using cameras located throughout the site, *Re-Haunting* will document Erring on the Mount as a ghostly performance of captured and printed images.

John Marris is a writer, photographer, painter, land-art maker, and creative collaborator who came to Peterborough to study for his Ph.D. at Trent University. His artistic interests include using art as a form of collaborative community engagement, and as a tool for exploring our connections to both natural and human-created processes of change and decay.

**No Man's Land**

No Man's Land is a distinct visual art exhibition within Erring on the Mount featuring the work of eight female artists investigating women's space(s) - emotional, psychological, physical and spiritual. Their installations, in the pink corridor on the first floor, explore the intersection of the equally contentious paradigms of Christianity and Feminism. Curated by Judith A. Mason, the works are inspired by the Sisters, and the site that was once their home.

**10 Rowena Dykins: *Monarch Migration***

*Monarch Migration* is a reflection and meditation on ephemerality, migration and survival.

Rowena Dykins, painter, installation artist and art educator, studied fine art at the School of Art & Design at the Montreal Museum of Fine Arts and Concordia University.

**12 Mary Kainer: *Path of Righteousness***

This drawing installation contrasts societal vices - greed, vanity, gambling, drug and sex trades, over-population- to the virtuous lives of the Sisters.

Mary Kainer employs drawing, painting, sculpture, photography, video and installation in her practice. She divides her time between Toronto and Apsley.

**8 Ramune Luminaire: *Have You No Shame? and No Shame***

Walls covered in graphite writing and drawings surround a small knitted figure suspended over a single bed... *Have You No Shame?* and *No Shame* explore the divide between the physical body and societal conventions.

Ramune Luminaire is a visual artist, author and teacher who seeks to find a place and a form for the expression of female sexuality.

**11 Judith A. Mason: *The three sisters, the incidents and the sepulcher***

Painterly forms, hybrid beings and haunting vignettes explore the unstable and complex relationships of women - as mother, lover and designated 'other.'

Judith A. Mason is a practicing artist, writer, teacher and curator. Her work often considers the conflict between the inner life and contemporary culture.

**6 Holly McClellan: *Mount St. Joseph's Garbage Dress Series***

Unwanted clothing is collected through a public appeal, then donated to charity. This installation is part of an ongoing series of "Garbage Dresses."

Holly McClellan is a graduate of York University and Sheridan College, she teaches digital photography and fine art at Durham College, and in her own artistic practice she is influenced by suburban living, consumerism, and their connection to the environment.

**13 Margaret Rodgers: *Ribbon, Lace and Silt Cloth: Handiwork for a Modern World***

The seventeenth century Sisters of St. Joseph made ribbon and lace. This is depicted on a banner using silt cloth and lace from a bridal shop.

Margaret Rodgers is an Oshawa-based visual artist and writer, founder of IRIS, as well as Director/Curator at Visual Art Centre Clarington.

**7 Joan Scaglione:** *Black Madonna*

*Black Madonna* is constructed from burned wood, and kneels on a mound of earth, her body folding into a spiral, her arms reach out into the cosmos.

Joan Scaglione received her MFA from the University of Regina -she now lives in Kingston Ontario where she practices and teaches art.

**8 Sally Thurlow:** *What The Nun Told Me*

An empty claw-foot tub and nightgown are watched over by a pair of crows, the tub's occupant having ascended to another plane...

Sally Thurlow is a Toronto based multi-disciplinary artist. She questions environmental practices relating to our current geographic and cultural situation.

**28 Beth McCubbin:** *Eternal Spirit*

The internal, untroubled, devout belief of a woman lost in a thoughtful moment.

Beth McCubbin lives in Hull, Quebec, having recently left her beloved arts community of Peterborough. In her artwork Beth seeks to represent the alternative, the over-looked, the forgotten, and the undesirable.

**4 Tegan Moss and Paul Atchison:** *The Clock*

Using iconography from various sources, *The Clock* reminds us that time is an abstraction.

Tegan Moss seeks transformation through her installation and movement based art. Paul Atchison has only recently admitted to being an artist.

**39 Kelly O'Neill:** *In Search of Sanctuary*

With troubled mind, where does one go, but in search of sanctuary? This work draws the viewer into an inner landscape examining visions of solitude, vulnerability, pain and courage.

Kelly O'Neill is a mixed-media and textile artist who has recently begun creating small sculptural pieces using found objects.

**29 Paul Oldham:** *Interstices*

Definition: a space that intervenes between things; especially: one between closely spaced things.

Paul Oldham is a practicing artist who divides his time between stained glass, painting, and creative carpentry, his work for Erring fits somewhere in between all these.

**30 Laurel Paluck:** *Dream Machine: Sleep Now*

A collection of dreams gathered from around the world for participants to experience, share and contribute to.

Laurel Paluck is an interdisciplinary artist who creates performance works which draw on theatre, literature and visual arts.

**40 Michael Poulton:** *Unfinished Business ~ a sound art installation for two voices*

with voices by Leigh Macdonald, Laurel Paluck, and Daphne Molson  
A small room in a nursing home that has ceased operation... two voices can be heard... the internal monologues of each woman's unfinished business with the other.

Michael Poulton is an award winning multi-disciplinary artist and curator of the Museum of Temporary Art, a fusion of museum, contemporary art institution and conceptual art piece.

**27 Quilt Arts Peterborough:** *The Sisters - their Pathway*

Comprised of seven panels by seven quilters, using both traditional and non-traditional techniques, Quilt Arts Peterborough depicts the many contributions the Sisters have made to the Peterborough community.

Quilt Arts Peterborough is Elke Bade, Judith Maher, Maureen O'Neill, Mary-Claire Nepotiuk, Blythe Minty, Susan Hubay, and Maureen McKeen

**51 Deb Reynolds:** *Questions That Have No Right to Go Away*

This interactive installation asks visitors to consider the parallels between artists and nuns, and the questions of life 'that will not go away' (David Whyte). Visitors are invited to use manual typewriters to answer the questions, and add their work to the installation in the gathering space.

Deb Reynolds is a multi-disciplinary artist with specialties in clown and open-eyed dreaming. She believes that art is for, and in, everyone.

**43 Bronson Smith:** *PROSTATE CANCER - "the radiation series"*

*The Radiation Series* chronicles Smith's seven-week treatment for prostate cancer at the Peterborough Regional Health Centre in 2013.

Bronson Smith has been practicing his unique artwork, modern primitive wood paintings, for over 30 years.

**34 Gillian Turnham and Hartley Stephenson:** *The Fall*

Interactive staircase installation featuring slinkies, a marble-run, and plenty more. Join us for a chance at ascension, or simply come to witness "The Fall".

Gillian Turnham employs traditional hand-craftsmanship techniques on non-traditional and found materials, focusing thematically on architecture, repetition, and the narrative form. Hartley Stephenson uses the detritus of modern consumerist society to comment on the political and social milieu of our times.

**Esther Vincent:** *Walking Mural*

A visual exploration of the viewer's path through Erring. A guide. A mystery. A map.

Esther Vincent is a polymath whose expertise ranges from visual and performing arts production to arts management and horsemanship. Her current passion is photography.

# FLOOR PLANS

## 1<sup>ST</sup> FLOOR + GROUND FLOOR

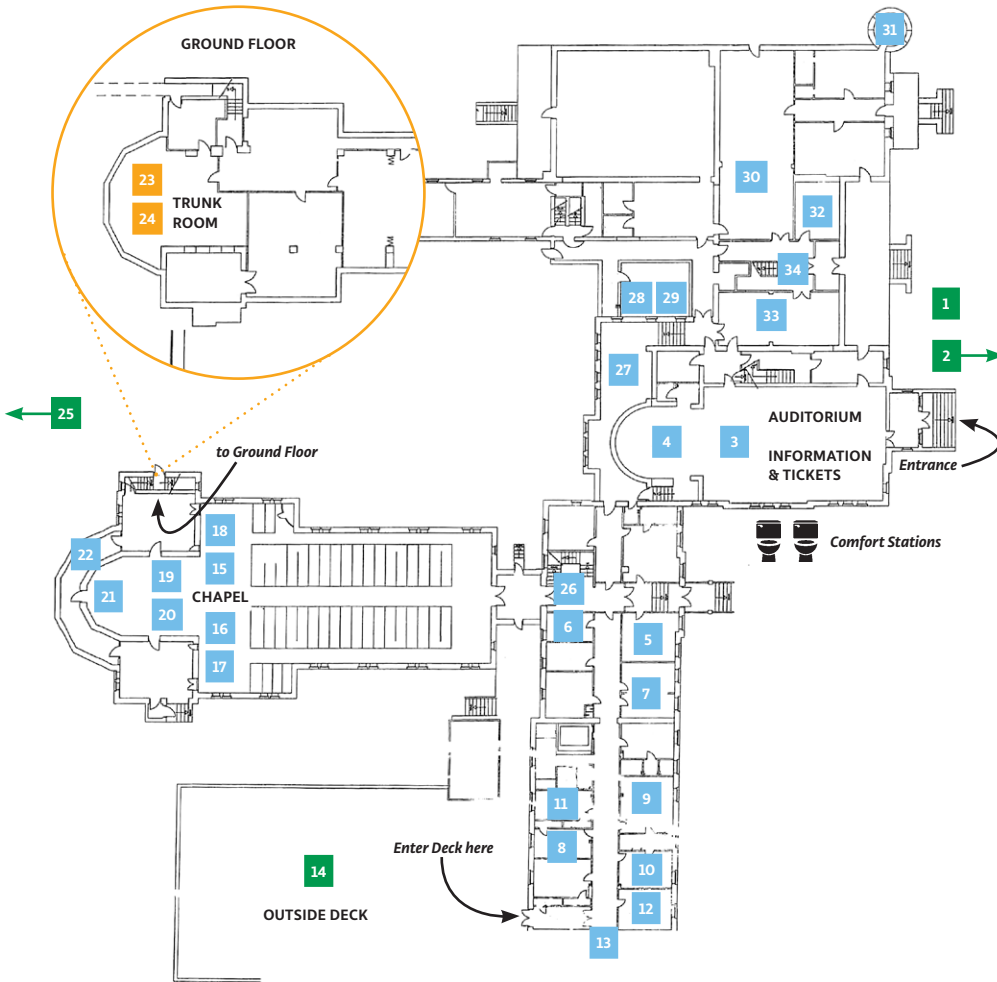

- 1 P. Cade, 2 J. Jarvis, 3 A. Gaensbauer, 4 T. Moss, 5 J. Marris, 6 H. McClellan,
- 7 J. Scaglione, 8 S. Thurlow, 9 R. Luminaire, 10 R. Dykins, 11 J. A. Mason,
- 12 M. Kainer, 13 M. Rodgers, 14 D. Bateman and E. Glasspool, 15 J. Elchuk,
- 16 The Zippa Dee Doo Dah Soul Chorus, 17 K. Adamson, 18 New Stages Theatre,
- 19 S. Newman, 20 R. Edmondson, 21 C. Kuntz, 22 J.-P. Campeau, 23 J. Jarvis,
- 24 K. Story, 25 T. Olszewski, 26 D. Back and S. Bradley, 27 Quilt Arts Peterborough,
- 28 B. McCubbin, 29 P. Oldham, 30 L. Paluck, 31 L. Macdonald, 32 L. Alfonso,
- 33 J. Rowland, 34 G. Turnham and H. Stephenson.

# FLOOR PLANS

## 2<sup>ND</sup> FLOOR

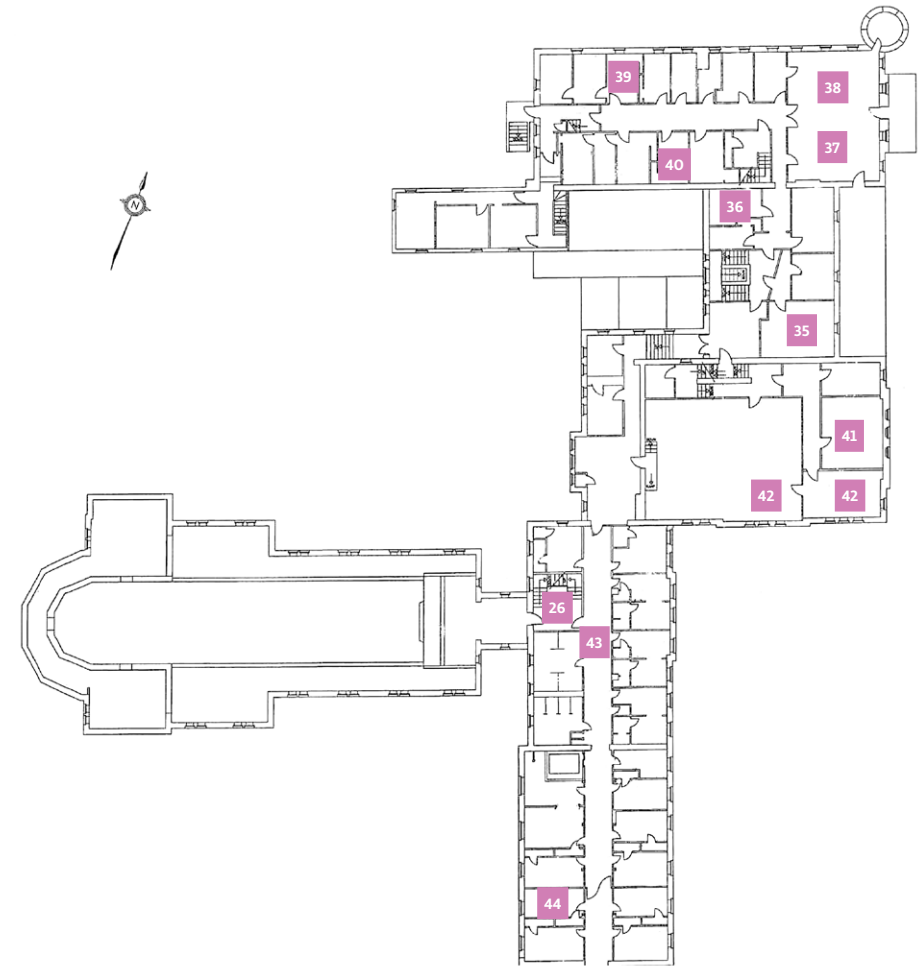

- 26 D. Back and S. Bradley, 35 B. Brackenridge, 36 C. Stoeten, 37 H. Rivison,
- 38 R. Kerr, 39 K. O'Neill, 40 M. Poulton, 41 J. Cole, 42 J. Graham, 43 B. Smith,
- 44 J. Macklin and P. Chee

# FLOOR PLANS

## 3<sup>RD</sup> FLOOR

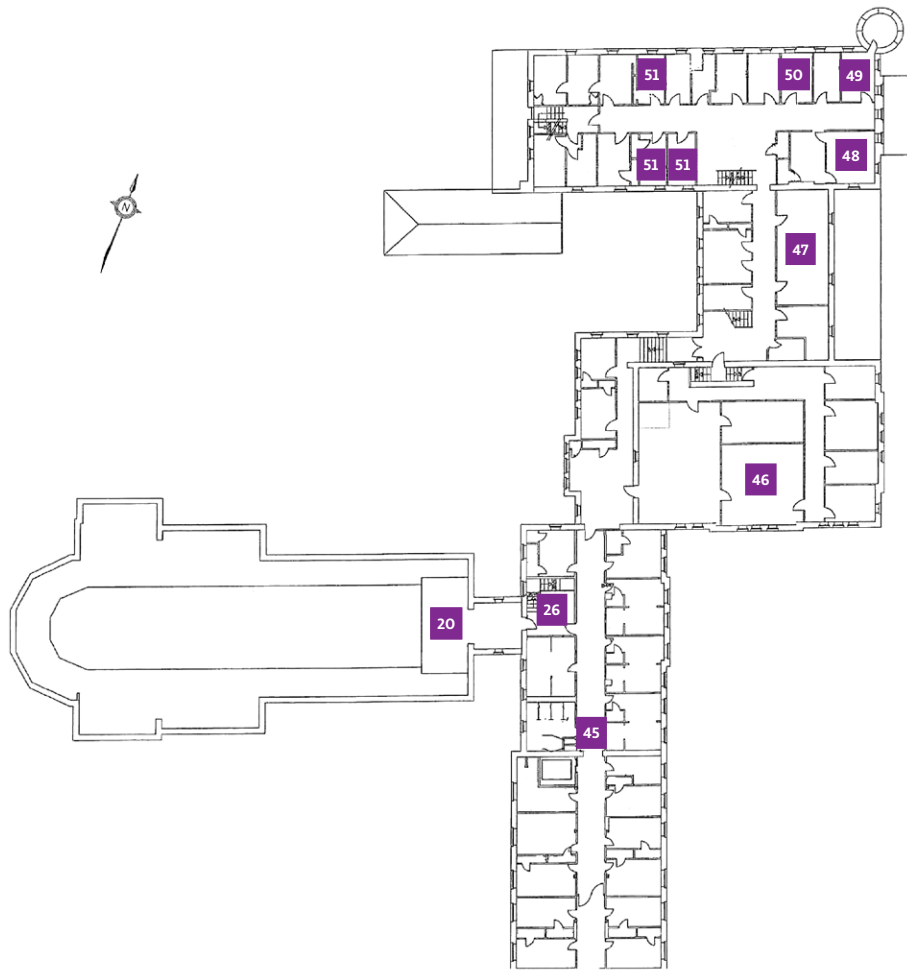

- 20 B. Edmondson, 26 D. Back and S. Bradley, 45 A. Mark and S. Morgan,
- 46 S. McNeilly, 47 K. Blackwell, 48 A. Jaeger, 49 J. Argue, 50 D. Maher,
- 51 D. Reynolds

## ABOUT PUBLIC ENERGY

Public Energy is an animator of contemporary dance, theatre, performance, and interdisciplinary work. We are committed to supporting the creation, touring, and presentation of innovative contemporary performance arts, and to developing audiences that are knowledgeable and passionate.

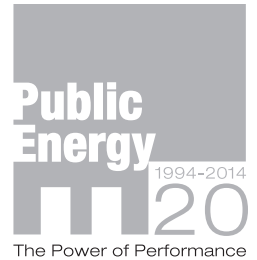

### BOARD OF DIRECTORS

Charmaine Eddy (*President*)  
 Barbara Chisholm  
 Sarah Gencey  
 Bill Kimball  
 Martha Whatley  
 Reem Yassawi

### STAFF

**Artistic Producer** Bill Kimball  
**General Manager** Tara Lember  
**Development Director** Simone Georges  
**Marketing Coordinator** Michael Fazackerly  
**Technical Director** Ryan Kerr  
**Bookkeeping** Susan Newman  
**Video Services** Powerhouse Digital Video

## THANK-YOU TO OUR SUPPORTERS

### GEOTHERMAL (\$1,000+)

Barbara Chisholm & Thomas Miller, Charmaine Eddy & Norm Slater, Sarah Gencey & Rob Wilkes, Martha & Richard Whatley

### HYDROGEN (\$500+)

Jim Angel, Simone Georges & Peter Bialogrecki, Laurie Thomson

### WIND (\$100+)

Cath Adele, Fred Begg, Deborah & Michael Berrill, Shirl Delarue & Joanne Brown, Nadine Changfoot, Julia & Philip Cockshutt, Curtis Driedger & Barbara Ratz, Su Ditta, Margaret Cockshutt, Lisa Dixon, Patricia Dixon, Gordon & Adele Finney, Joan Kimball, Jonathan Fiddler, Rob Fortin & Susan Newman, Rosemary Ganley, Neil Hannam, Julia Harrison, Jo Hayward-Haines, Veronica Hollinger, Sarah Lawson & Jagger Smith, Carol Love, Louis & Judith MacLellan, Tom McHugh & Cathy Flindall, Catherine Owens, Patricia Quinn, Doug & Sigrid Rishor, John Rubie, Jyoti Sapra-Shannon, Joy Simmonds & Colin MacAdam, Monkman, Gracie & Johnston, Alan & Linda Slavin, Rob Steinman, Jane Stewart, Ravi-Inder Soligo, John Wadland

### SOLAR (\$25+)

Jim Abel, Mary Lynn Anderson, Karen August, Bethune St. Brain Trust, Liliana & Mitch Brownstein, Paul Clifford, Susan Cooper, Julie & Kirk Dillon, John & Joan Higginson, Sheena Howard, Catherine Jeffery, Dorothy Mulders-Langlois, Brittany Lehmann-Bender, David Morrison, Randy Read, Celeste Scopelites, Katherine Orgill & Bruce Scott, Wendy Trusler, Charlie & Jane Werger, D.M. & Eleanor Wyslouzil

BECOME A PUBLIC ENERGY SUPPORTER Public Energy is a registered charity, # 89481 1058 RR 0001. Tax deductible donations can be made on line at [www.canadahelps.org](http://www.canadahelps.org).

### CONTACT US

**email:** [admin@publicenergy.ca](mailto:admin@publicenergy.ca)  
**mail:** PO Box 2319 Peterborough, ON Canada K9J 7Y8  
**phone:** (705) 745-1788

### SEASON SPONSORS AND FUNDERS





# HOW TO FIND US

THE MOUNT COMMUNITY CENTRE  
1555 MONAGHAN ROAD, PETERBOROUGH, ONTARIO

**Biking or walking:** The Mount is a 20-minute walk or 5-minute bike ride from downtown. You can use part of the Trans-Canada Trail to get there. We have plenty of bike racks, brought in especially for Erring on the Mount.

**By bus:** Use City of Peterborough Transit Route #4 to get from the downtown terminal to a bus stop at the main entrance at the corner of Monaghan Road and McDonnell Street.

**Parking:** There is parking off Woodland Street on the south side of the property, located very near the main entrance.



Courtesy of Peterborough County & City Cycling & Trails Map

**Come prepared:** Erring on the Mount takes place in a building undergoing a transformation after being unused for 5 years; parts of it are still musty, there is no running water and the elevators are not in service. There are many stairs to negotiate if you want to experience everything, and you will have to go outside to take advantage of our comfort stations. So bring a good pair of walking shoes, a bottle of water, and a spirit of adventure as you make your way around Erring on the Mount.

## ERRING ON THE MOUNT SHOW SPONSORS AND FUNDERS

